

BRIDGEPORT ELEMENTARY SCHOOL

- Replace playground blacktop
- Relocate main office to front of school
- Rebuild front breeze way
- Replace cafeteria floor tiles
- Upgrade fire alarm system
- Install Security Cameras
- Replace blue sheet metal roofing
- Repair leaks in covered play structure
- Build permanent walls where needed (district small project facility funds)
- Update restrooms
- HVAC improvements
- Interior door locks that can be locked from the inside the classroom
- Keycard locks for all exterior doors
- New and replacement technology and curriculum

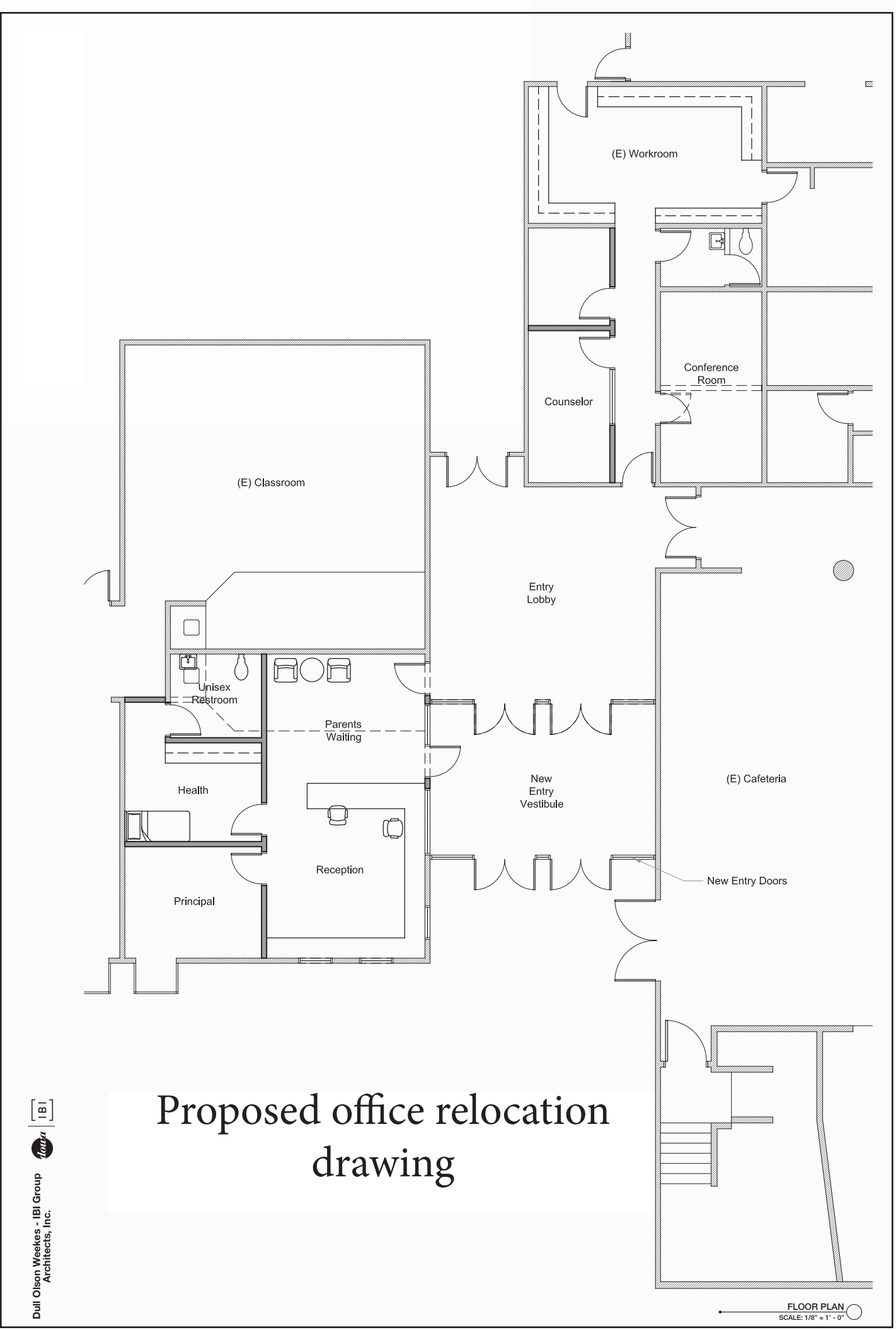

SW 16th Ct
TUALATIN HIGH SCHOOL

Expand School to accommodate existing and projected enrollments including:

- Build a 6-room classroom wing and expand TECH wing;
- Enlarge "Commons"/lunchroom to provide space to serve 900 students each lunch; add restrooms;
- Move main office to center of school and convert existing office area into classrooms;
- Enlarge girls and boys locker rooms and build multi-purpose P.E. space; install multi-purpose turf field.

TIGARD-TUALATIN SCHOOL DISTRICT FACILITY PLANNING 2016